



Recline Adjuster, Slide/Up-down Adjuster Replacement

CAUTION: Wear gloves to remove and install the recline adjuster and slide/up-down adjuster.

NOTE:

- Take care not to scratch the seat covers.
- To separate the recline adjuster and slide/up-down adjuster, elevate the seat cushion at the front and rear.
- Remove the front seat (see page 20-46).
- Remove the seat cushion and seat-back (see page 20-46).

1. Remove the power seat switch.

►: Screw locations, 2

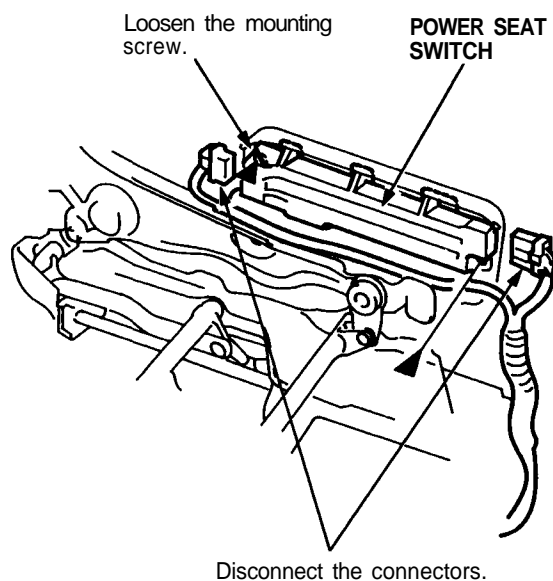

2. Separate the recline adjuster and slide/up-down adjuster.

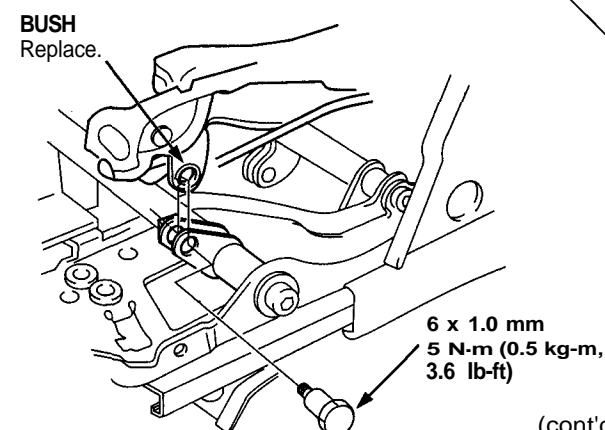
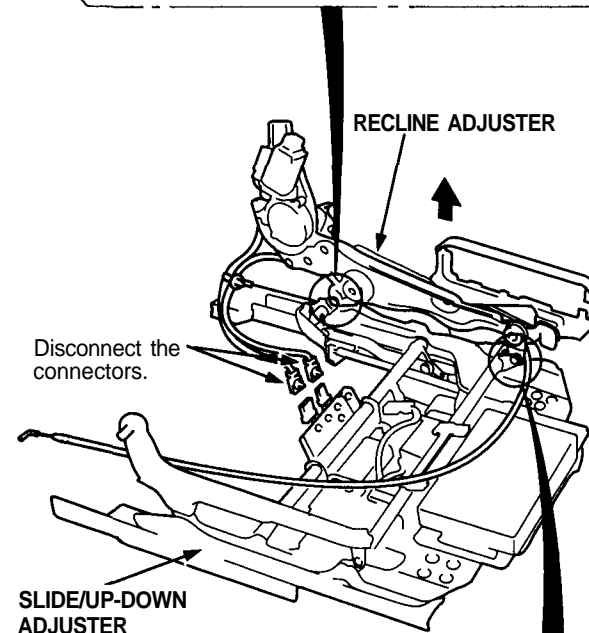
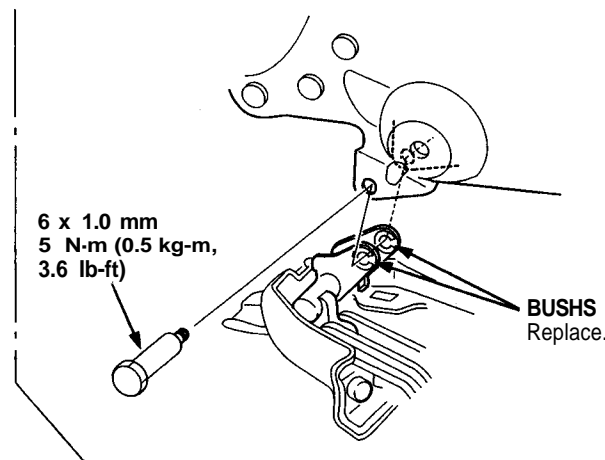

(cont'd)

Front Seat Linkage

Recline Adjuster, Slide/Up-down Adjuster Replacement (cont'd)

3. Remove the slide joint cable (see page 20-64).
4. Remove the seat memory control unit and harness protector from the slide/up-down adjuster. Disconnect the connectors.

▷: Clip locations, 2

-1)

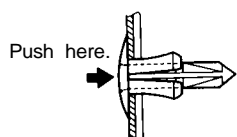

-2) Detach the clip by pulling it.

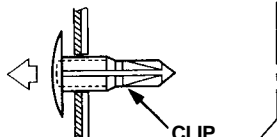

▶: Bolt locations, 4

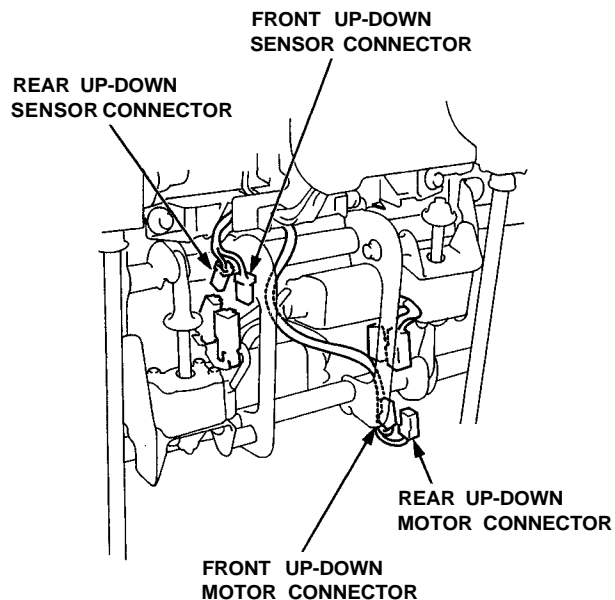
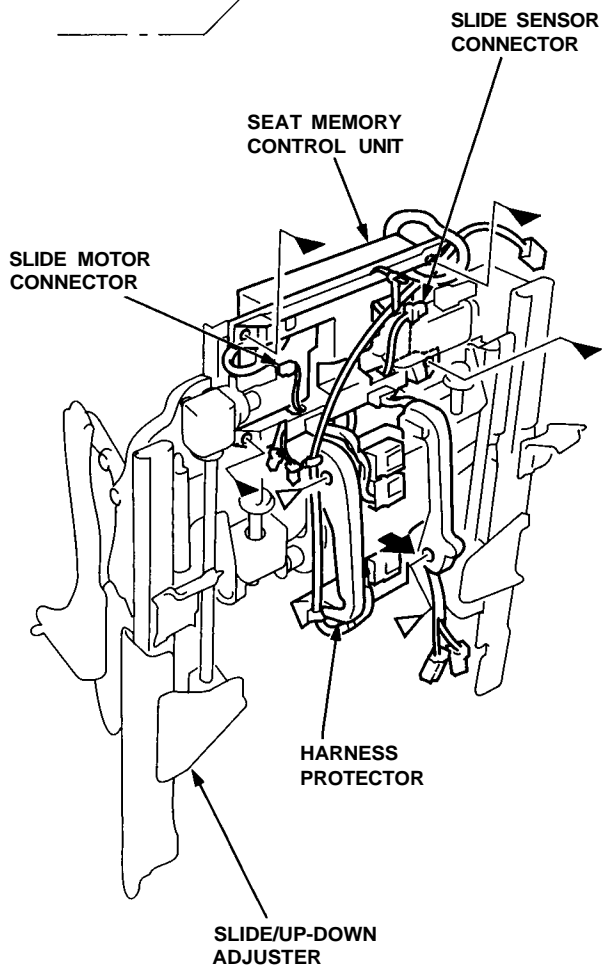
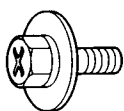

5. Remove the lower caps on both sides.

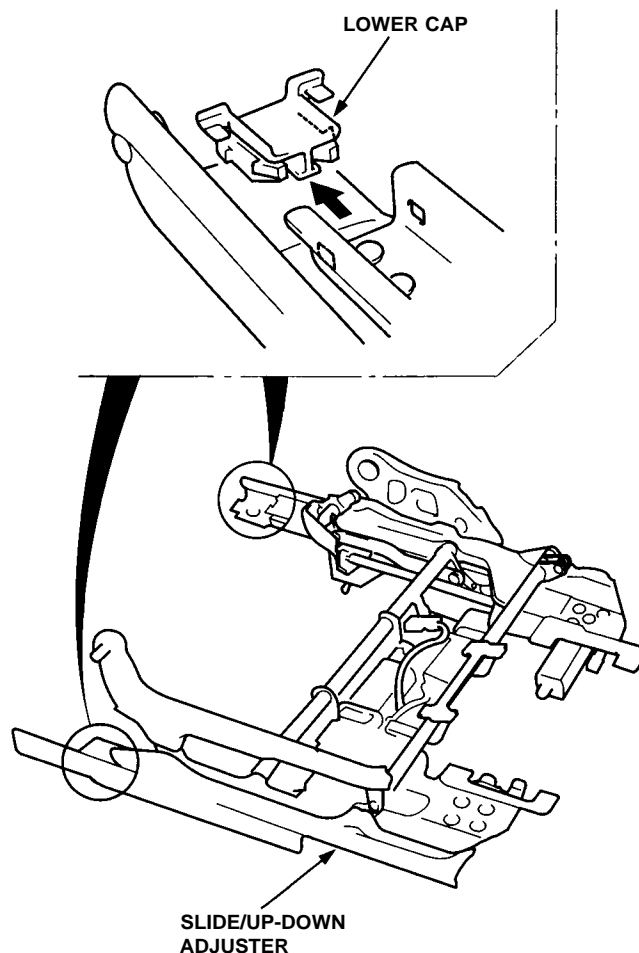



6. Installation is the reverse of the removal procedure.

NOTE:

- Replace the bushs with new ones as follows

– 1) Install the bush.

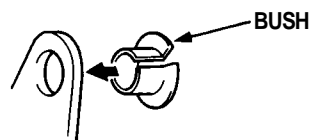

– 2) Hold the bush down against a metal plate, then flare the edge of the bush using a center punch as shown.

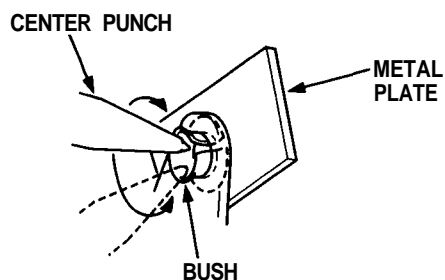

– 3) Flatten the bush using a flat tip screwdriver as shown.

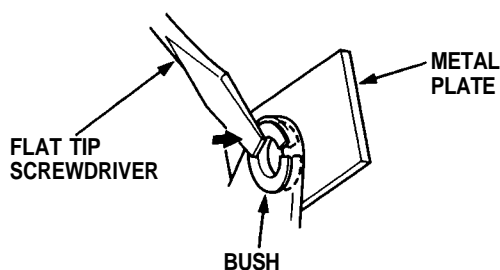

- Make sure the slide joint cable is connected securely (see page [20-65](#)).

- Make sure the connectors are connected properly.

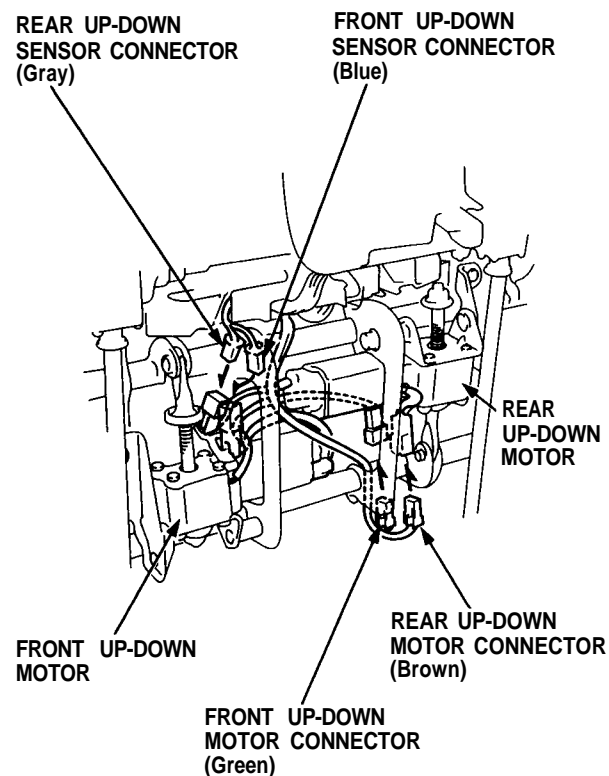
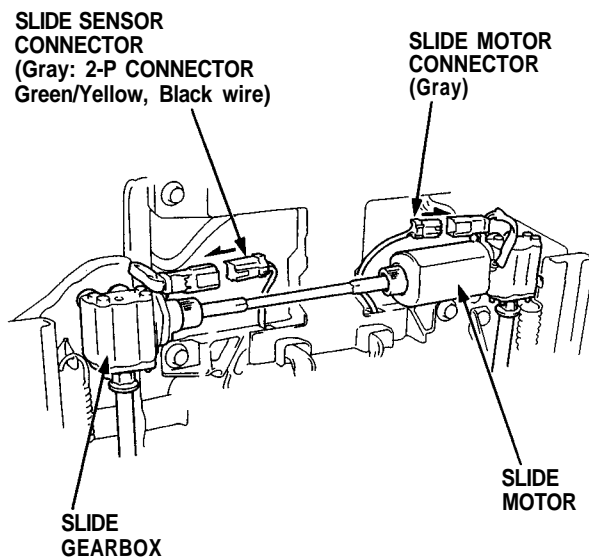

- Check the recline adjuster and slide/up-down adjuster operations.